



SC101



SC102



SC111



SC301-i



SC302-i



SC375

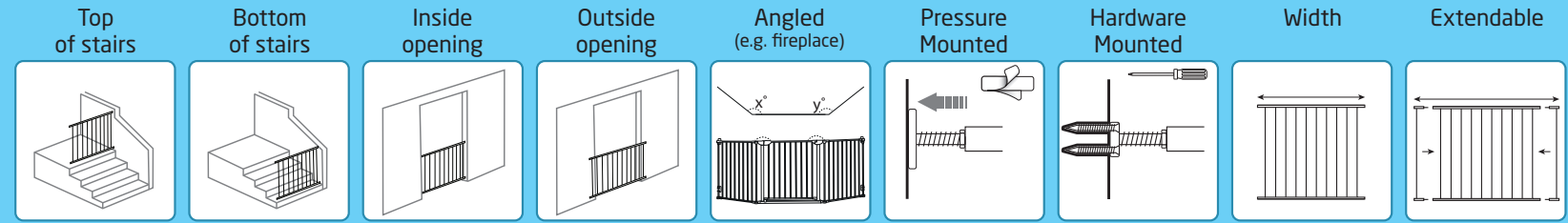

| | Top of stairs | Bottom of stairs | Inside opening | Outside opening | Angled (e.g. fireplace) | Pressure Mounted | Hardware Mounted | Width | Extendable |
|---|---------------|------------------|----------------|-----------------|-------------------------|------------------|------------------|-----------------|---|
| SafeGate Extending Basic SC101 Opt. colour: Dark Grey | ✓ | ✓ | ✓ | ✗ | ✗ | ✗ | ✓ | 68 - 106 cm | ✗ |
| SafeGate Kindergarten Gate SC102 | ✓ | ✓ | ✓ | ✓ | ✗ | ✗ | ✓ | 74.5 - 117.5 cm | ✗ |
| SafeGate Extending Advanced SC111 Opt. colour: Dark Grey | ✓ | ✓ | ✓ | ✓ | ✗ | ✗ | ✓ | 66 - 110 cm | ✗ |
| SafeGate Auto Close Advisor SC301-i *Expires in favour of SC302-i | ✗ | ✓ | ✓ | ✗ | ✗ | ✓ | ✗ | 74.5-79.5 cm | 1 ext: 79.5 - 86.5 cm 2 ext: 86.5 - 93.5 cm 3 ext: 93.5 - 100.5 cm 4 ext: 100.5 - 107.5 cm Extension = Art. No. SC901 |
| SafeGate Auto Close Advisor SC302-i | ✗ | ✓ | ✓ | ✗ | ✗ | ✓ | ✗ | 78.5 - 83.5 cm | 1 ext: 83.5 - 90.5 cm 2 ext: 90.5 - 97.5 cm 3 ext: 97.5 - 104.5 cm 4 ext: 104.5 - 111.5 cm Extension = Art. No. SC901 |
| SafeGate Swing Shut Gate SC375 | ✗ | ✓ | ✓ | ✗ | ✗ | ✓ | ✗ | 73.5 - 78.5 cm | 1 ext: 78.5 - 83.5 cm 2 ext: 83.5 - 88.5 cm Extension = Art. No. SC903 |
| SafeGate Constructor 2 SC701-80 Opt. colour: Dark Grey | ✗ | ✓ | ✓ | ✓ | ✓ | ✗ | ✓ | 90 - 210 cm | Can be extended unlimited with extra extension panels. Extensions: Art. No. SC715-20 (20 cm) Art. No. SC715-60 (60 cm) |
| SafeGate Constructor 4 SC702-80 Opt. colour: Dark Grey | ✗ | ✓ | ✓ | ✓ | ✓ | ✗ | ✓ | 90 - 330 cm | |
| SafeGate Wood Hardware Mounted SC500 Opt. colour: Dark Brown | ✓ | ✓ | ✓ | ✓ | ✗ | ✗ | ✓ | 76 - 105 cm | ✗ |
| SafeGate Clear-view Hardware Mounted SC510 | ✓ | ✓ | ✓ | ✓ | ✗ | ✗ | ✓ | 75 - 100 cm | ✗ |
| SafeGate Wood Pressure Mounted SC531 Opt. colour: Dark Brown | ✗ | ✓ | ✓ | ✗ | ✗ | ✓ | ✗ | 76 - 82 cm | 1 ext:** 82 - 89 cm 2 ext:** 89 - 96 cm 3 ext: 96 - 103 cm 4 ext: 103 - 110 cm 5 ext: 110 - 117 cm 6 ext: 117 - 124 cm **2 ext. included in package Extension = Art. No. SC540 |
| SafeGate Clear-view Pressure Mounted SC532 | ✗ | ✓ | ✓ | ✗ | ✗ | ✓ | ✗ | | |



SC701-80



SC702-80



SC500

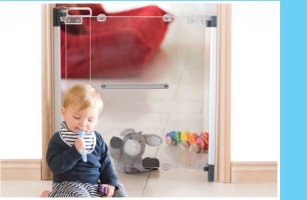

SC510



SC531

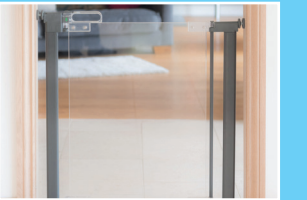

SC532







- scan to explore our wide range of top quality safety products

www.safeandcareco.com

Gate Accessories

Extensions

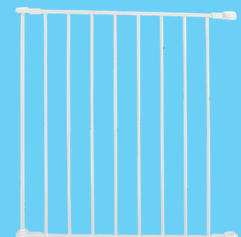
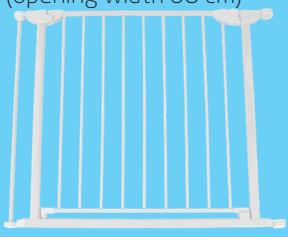
| | | | | | |
|--|---|---|---|---|---|
| 2 x 7 cm | 7 cm | 7 cm | 20 cm | 60 cm | Door Section 80 cm (opening width 68 cm) |
|  |  |  |  |  |  |
| SC-540-01-01 (SC540-03-03 = Dark Grey) | SC-901-01-01 | SC-903-01-01 | SC-715-20-01-01 (SC715-20-03-03 = Dark Grey) | SC-715-60-01-01 (SC715-60-03-03 = Dark Grey) | SC-716-80-01-01 (SC716-80-03-03 = Dark Grey) |

Fittings

| | | |
|---|---|---|
| Stair Flex | Baseboard Protection Kit | Y-Spindle |
|  |  |  |
| SC-906-01-01 SC906-03-03 = Dark Grey) | SC-907-01-01 SC907-03-03 = Dark Grey) | SC-905-01-01 SC905-03-03 = Dark Grey) |

The SAFE guide to your Safety Gate

